

## **AIR PRESSURE SWITCHES DIFFERENTIAL · VACUUM · PRESSURE**

- FEATURES:**
- COMPACT ■ ACCURATE ■ EASY TO INSTALL ■ ADJUSTABLE
  - SENSITIVE (.05") ■ DEPENDABLE ■ COST EFFECTIVE PRICING!
  - CUSTOMER SPECIFIED FITTINGS AND BRACKET. ■ BOTTOM MACHINE THREAD OPTION. 1/2"-14 AND 3/4"-14 AVAILABLE.

## **Assure Reliability and Efficiency with Accurate Check Air Flow**

Antunes Controls is one of the leading manufacturers of pressure control switches. Our new sheet metal air differential switches are compact, sensitive, and reliable with trouble free operation. Their design is based on the same principles of reliability, repeatability, and accuracy that has made

Antunes Controls existing line of pressure switches so successful. Their construction incorporates a sensitive diaphragm and a snap action electrical switch. The switch is available with adjustable settings of .05" W.C. to 1" W.C., and .05" W.C. to 9" W.C.

# SPECIFICATIONS:

## ALL MODELS:

Max. Surge Pressure 30" W.C.  
 Max. Ambient Temperature 170°F  
 Min. Ambient Temperature - 40°F

## ELECTRICAL RATING:

10A @ 125, 8A @ 250, 7A @ 277 Vac.  
 1/8 HP @ 125 Vac. 1/4 HP @ 250 Vac.  
 Pilot Duty 125VA @ 125/277 Vac.

## FITTINGS (STANDARD)

1/4" Barb  
 1/4" Tube  
 1/4" Compression  
 Consult factory for other fittings.

Option: Neon Light Indicator

## DIMENSIONS

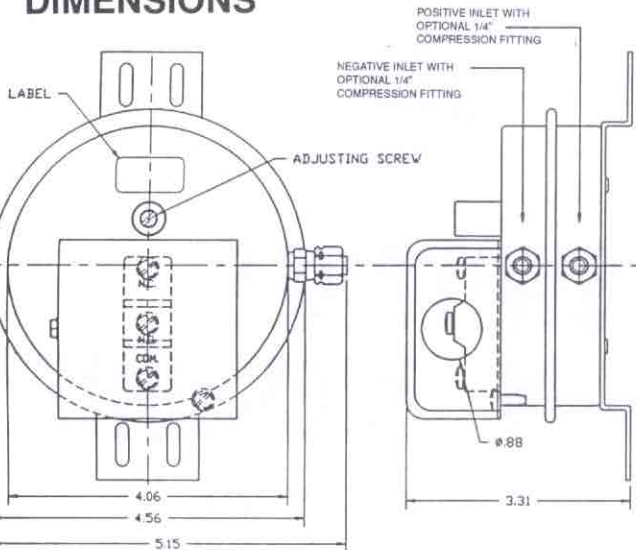

## LOCATION OF INLETS (Standard)

Adjustable  
 Differential  
 Side Inlets

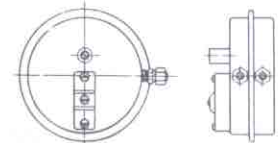

Non-Adjustable  
 Differential  
 Side Inlets

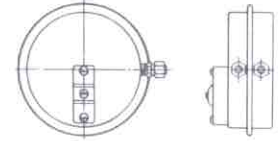

Adjustable  
 differential  
 one side inlet  
 and machine  
 thread adapter  
 with nut. Specify 1/2"-14  
 NPSH or 3/4"-14 NPSH

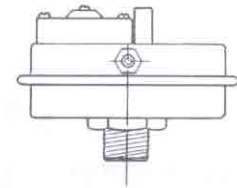

SPECIFY OTHER INLET LOCATIONS.

## NOTE:

Standard mounting bracket  
 is shown.  
 For other mounting  
 arrangements contact factory.

**LIMITATION OF LIABILITY.** It is understood and agreed that seller's liability whether in contract, in tort, under any warranty, in negligence or otherwise shall not exceed the return of the amount of the purchase price paid by purchaser and under no circumstances shall seller be liable for special,

indirect or consequential damages. The price stated for the equipment is a consideration in limiting seller's liability. No action, regardless of form, arising out of the transactions may be brought by purchaser more than one year after the cause of action has accrued.

# ANTUNES CONTROLS

DIVISION OF A.J. ANTUNES & CO.

180 KEHOE BLVD., P.O. BOX 87700, CAROL STREAM, IL 60188 • PHONE 630-784-1000 • 1-800-253-2991 • FAX 630-784-1651  
 www.antunescontrols.com